

## DATASHEET

## Pressure

## Pressure Transmitter

### For high-temp melt applications

#### Model PWP124 Series



PWP124-111



PWP124-112



PWP124-121



PWP124-123

#### Applications

- Plastic extrusion machine
- Rubber manufacturing equipment
- Chemical fiber drawing equipment
- High temperature systems
- High pressure systems
- Laboratory equipment
- Petro-chemical application
- Medicine, food processing, packaging equipment

#### Features

- Internal 80% calibration signal
- Good stability and repeatability
- 15-5PH diaphragm material
- Maximum temperature resistance 400°C
- Large measuring range 150MPa
- Accuracy  $\pm 0.5\%$ FS
- Both pressure and temperature measurement
- Various pressure connection to suit the equipment

## Description

PWP124 Series high temperature melt pressure transmitter is a straight rod/soft cable melt pressure transmitter. Some models equipped with a temperature measuring thermocouple to achieve the same-point measurement of pressure and temperature. Widely used in plastic extrusion machines, chemical fiber and rubber manufacturing equipment, as well as other high temperature fluids, pressure and temperature process control monitoring.

Its advantages are accurate and reliable pressure measurement, amplified signals directly into the PLC control system, internal 80% calibration signal, simple installation, and high cost performance.

Pokcenser offer a wide range of products and services related to process, instrumentation and control applied to the different industries.

## Specifications

Model	PWP124-111; PWP124-112; PWP124-121; PWP124-123
Pressure Type	Relative (gauge) pressure
Pressure Range	0~500psi...20000psi / 0MPa~3.5MPa ...150MPa
Safe Overload	1.2 times Full Range
Burst Pressure	1.5 times Full Range
Electrical Connection	5 pins plug; 6 pins plug
IP Rating	IP65
Accuracy	±0.5%FS, ±0.25%FS
Signal Output &Power Supply	3.33mV/V, 2mV/V (Power 10VDC: 6-12V) 4-20mA, 0-5V, 0-10V (Power 24VDC: 12-36V)
Response Time	≤10ms
Diaphragm	Coated 15-5PH Stainless Steel
Medium Compatible	Media compatible with 15-5PH stainless steel and 316L
Insulation Resistance	200MΩ @100Vdc
Output Impedance	350 Ohms ±10%
Non-linear ( %FS )	±0.25%FS
Internal Auto-Calibration	80%FS ±1%
Hysteresis ( %FS )	±0.2%FS
Repeatability (%FS)	±0.2%FS
Working Temp.	0℃~400℃
Storage Temp.	-40℃~+120℃
Process Connection	1/2"-20UNF, M14x1.5, M18x1.5, M22x1.5, G3/4, or others
Thermocouple Type	J, K, E, PT100 optional
Explosion Proof	Exd II CT5

## Dimensions and Drawings

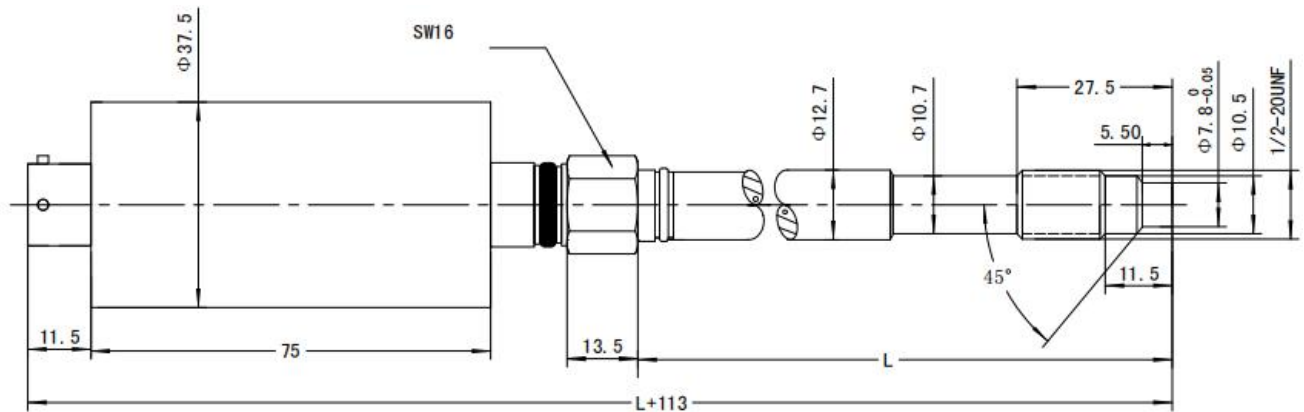

**PWP124-111**

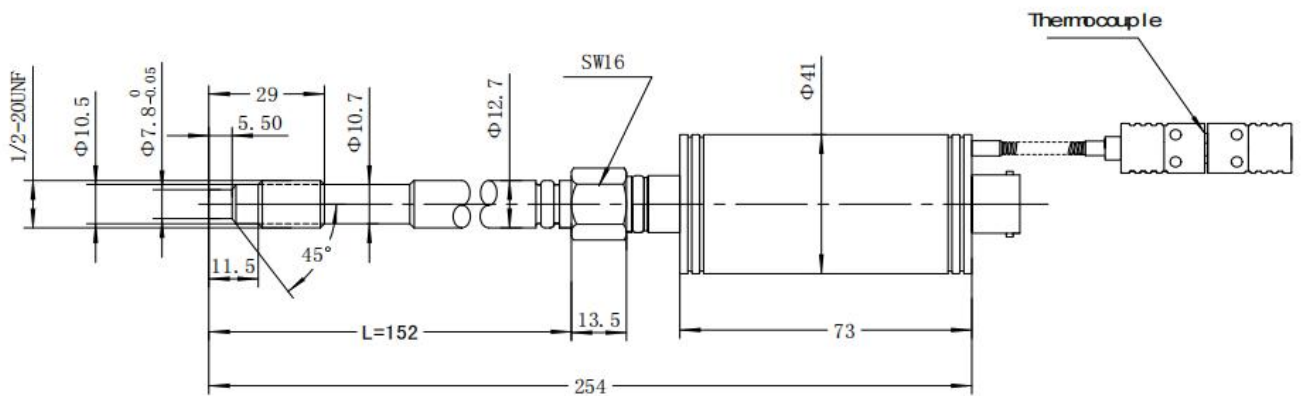

**PWP124-112**

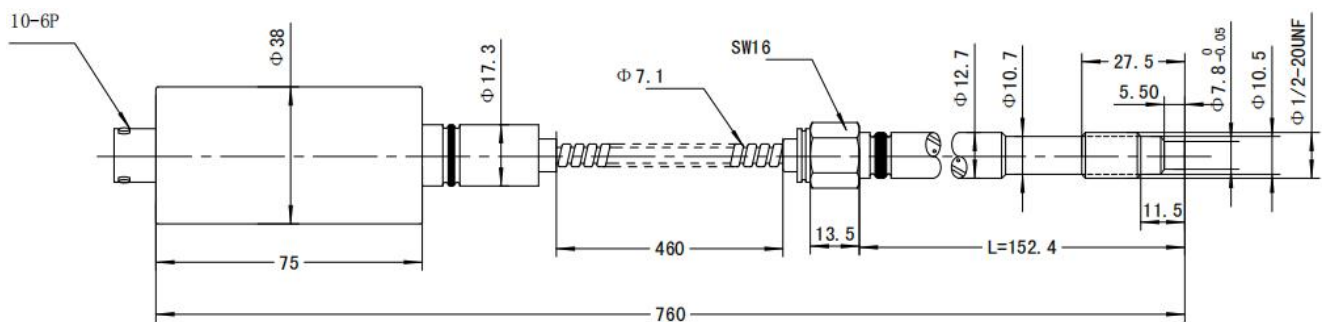

**PWP124-121**

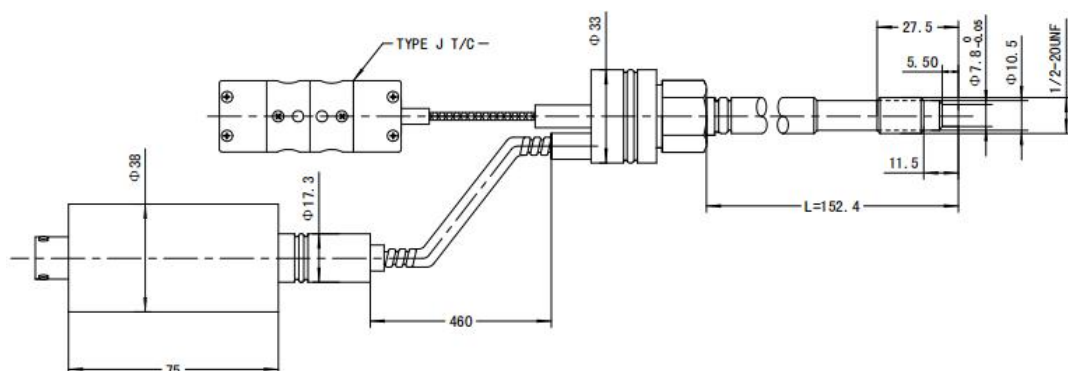

**PWP124-123**

## Electrical Connection

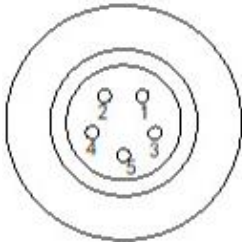
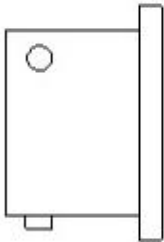
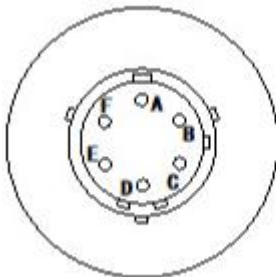
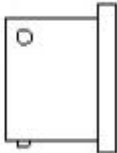
5 pins connector						
 	0-5V, 0-10V			4-20mA		
	5Pins	Function	Color	5Pins	Function	Color
	1	Signal +	Blue	1	Signal +	Blue
	2	Power +	Red	2	Power +	Red
	3	Signal -	White	4	Calibration	Yellow
	4	Power -	Yellow	5	Calibration	Black
5						
5						
6 pins connector						
 	0-5V, 0-10V			4-20mA		
	6Pins	Function	Color	6Pins	Function	Color
	A	Signal +	Blue	A	Power+/Signal+	Red
	B	Signal -	Green	B	Power-/Signal-	Blue
	C	Power +	Red	E	Calibration	Yellow
	D	Power -	Yellow	F	Calibration	Black
E						
F						
Calibration						
Black						

## How to Order

**Example Part Number: 124112E1[100]MT1KD2C1A2**

Series	PWP124 Melt Pressure Transmitter	124
Model No.	111=Rigid Stem Type 112=Rigid Stem + Thermocouple Type 121=Rigid Stem + Capillary Type 123=Rigid Stem + Capillary + Thermocouple Type	112
Electronic Connection	E1=5pins connector E2=6pins connector E0=Customized	E1
Pressure Range	0~500psi...20000psi / 0MPa~3.5MPa ...150MPa Gauge Directly write in []	[100]
Pressure Units	P=Psi M=MPa B=bar	M
Signal Output	T1=3.33mV/V T2=2mV/V	T1

	T3=4-20mA T4=0-5V T5=0-10V(3wires) T0=Customized	
Thermocouple Type	0=None J="J" type thermocouple K="K" type thermocouple E="E" type thermocouple P="PT100" type thermocouple	K
Stem&Capillary Dimension	D1=Rigid stem 6" or 152mm D2=Rigid stem 12" or 304mm D3=Rigid stem 18" or 456mm D4=Rigid stem 6" or 152mm and Capillary 18" or 457.2mm D5=Rigid stem 12" or 304mm and Capillary 18" or 457.2mm D0=By customization	D2
Pressure Connection	C1=1/2"-20UNF C2=M14x1.5 male C3=M18x1.5 male C4=M22x1.5 male C5=G3/4 male C0=Customized	C1
Accuracy	A1=1.0%F.S A2=0.5%F.S. A3=0.25%F.S.	A2

*\*\*Tell us medium / which application / measuring range / working temperature / signal output / what you wanna to realize, our sales engineer will recommend suitable model for you.*