

DATASHEET

Pressure

Pressure Transmitter

For Industrial Explosion-proof Applications

Model PWP350-X

Applications

- Oil & Gas
- Refineries and petrochemical industry
- Natural gas compressors
- Drilling platforms and pipeline
- Marine and vessel approved
- Diesel tank level monitoring
- Harsh and hazardous application

Features

- Imported chip, 0.25%F.S.
- Strong shock and erosion resistance
- IP68 waterproof protection
- Ex ia IICT6, ATEX approved
- High EMC/EMI protection
- 316L stainless diaphragm, welded SUS316L body construction



Pressure transmitter PWP350-X

Description

PWP350-X intrinsically safe pressure transmitter/transducer is designed to be used in hazardous environments, especially for the high standard requirements of industrial oil and gas sections applications. It has explosion proof Ex ia IICT6 ATEX approved.

The pressure transmitter is with 316L stainless steel diaphragm and fully welded stainless steel housing, features a high resistance to the vibration, moisture ingress and pressure spikes. Additionally, this pressure transmitter is IP68 waterproof rated. The fully sealed structure makes it ideal for installation in a hazardous environment.

PWP350-X pressure transmitter can be delivered with analog signals or digital RS485 RTU output, absolute or gauge(relative) pressure. Welcome your inquiry.

Specifications

Model	PWP350-X			
Pressure Type	Relative (gauge) /Absolute pressure/Sealed gauge pressure			
Pressure Range	-0.1MPa ... 0kPa~10kPa ... 100MPa			
Safe Overload	≤200%FS(<10MPa); ≤150%FS(≥10MPa)			
Burst Pressure	300%FS			
Electrical Connection	Directly cable outlet			
Water Proof	IP68			
Accuracy	±0.5%FS, ±0.25%FS, ±0.1%FS optional			
Signal Output & Power Supply	4-20mA(2 wires)	0.5-4.5V(3 wires)	0-5V(3 wires)	0-10V(3 wires)
	12-30VDC	5VDC	8-24VDC	12-30VDC

	I ² C	RS485 Modbus		
	3.3 or 5VDC	5-30VDC		
Response Time	≤3ms (10%~90%)			
Medium Compatible	Liquid compatible with stainless steel SUS316L material			
Load Resistance(2 wires)	R≤(U-10)/0.02-RD (U: Power supply, RD: Internal resistance in the cable)			
Total current consumption	Current signal(2wires): Max about 23mA Voltage signal(3wires): <5mA I ² C(4wires): <1.3mA (Available to customize low consumption <5 μA) RS485(4wires): <5mA (Available to customize low consumption <1.1mA)			
Accuracy&Performance	0.1% Accuracy Class	0.25% Accuracy Class	0.5% Accuracy Class	
Non-linear (%FS)	≤0.1	≤0.2	≤0.4	
Hysteresis (%FS)	≤0.05	≤0.05	≤0.1	
Repeatability (%FS)	≤0.05	≤0.05	≤0.1	
Long-term Stability (%FS/year)	≤0.1	≤0.2	≤0.5	
Zero Temp Drift (%FS/°C)	≤0.01	≤0.03	≤0.05	
Compensation Temp.	0℃~+50℃(≤200kPa), -10℃~+70℃(>200kPa)			
Working Temp.	-40℃~+85℃			
Storage Temp.	-40℃~+85℃			
Vibration Environment	10g (@10Hz~2000Hz)			
Impact Resistance	100g/11ms			
Service Life	>10 million load cycles (within measurement range)			
Explosion Proof	Ex ia IICT6			
EMC Standard	EN IEC 61326-1:2021; EN IEC 61326-2:2021			
Certificate	CE ATEX			

Dimensions and Drawings

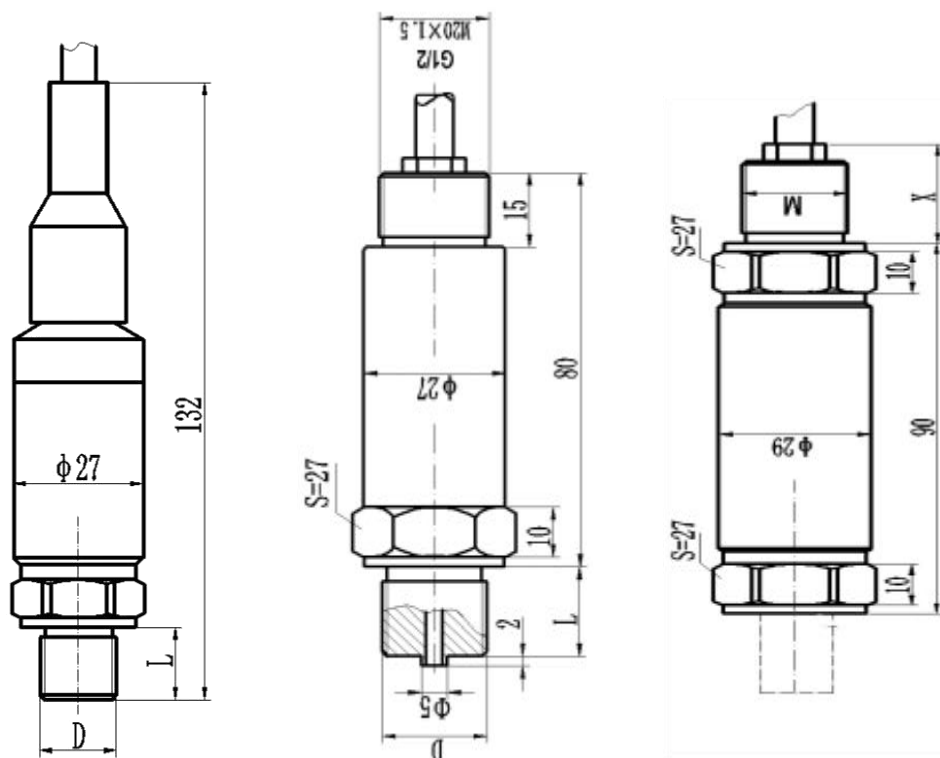

*Unit:mm. Typical structures. Other structures and dimensions can be customized.

Electrical Connection

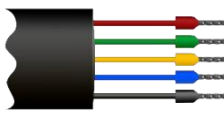
Directly outlet cable					
	Wire Color	Current(2wires)	Voltage(3wires)	IIC(4wires)	RS485(4wires)
	Red	Vcc	Vcc	Vcc	Vcc
	Green	Iout	GND	GND	GND
	Yellow	/	Vout	SCL	RS485A
	Blue	/	/	SDA	RS485B
	Black	PE	PE	PE	PE



How to Order

Example Part Number: 350XC[10]BGT1S2C4A2M1003

Model No.	PWP350-X	350X
Electronic Connection	C=Direct outlet cable 0=Customized	C
Pressure Range	-0.1MPa ... 0kPa~10kPa ... 100MPa Directly write in []	[10]
Pressure Units	B=bar P=Psi K=kPa M=MPa	B
Pressure Type	G= Gauge/Relative A=Absolute S=Sealed gauge pressure	G
Signal Output	T1=4-20mA(2wires) T2=0-5V(3wires) T3=1-5V(3wires) T4=0-10V(3wires) T5=0.5-4.5V(3wires) T6=I ² C(4wires) T7=RS485(4 wires) T0=Customized	T1
Power Supply	S1=8-24VDC S2=12-30VDC S3=5VDC S4=3.3VDC S5=5-30VDC S0=Customized	S2
Pressure Connection	C1=G1/4" male C2=1/4"NPT male C3=M20x1.5 male C4=G1/4" female C5=1/4"NPT female C6=G1/2"male C7=1/2" NPT male C0=Customized	C4
Accuracy	A1=0.5%F.S. A2=0.25%F.S. A3=0.1%F.S.	A2
Housing Material	M1=316L (Typical) M2=SUS304 M0=Customized	M1
Cable Length	001= 1m cable 002= 2m cable 003=3m cable ...	003

*Means to order: Pressure transmitter PWP350-X with directly cable outlet, 0~10 bar Gauge, 4-20mA, 12-30VDC, G1/4" female, 0.25%FS accuracy, 316L material housing, cable length is 3m.

You may also Need

Reference Picture	Description	Product
	To connect with pressure transmitter and to have a site indicator of the measured value, have high&low value alarms, record and control.	Display/indicator/controller
	Cast aluminum material with IP67 protection level for submersible pressure transmitter. Moisture-proof sealing design, insulation protection against electric shock. To be placed in dry environment or in a cabinet.	Terminal box 0010

***Tell us medium / which application / measuring range / working temperature / signal output / what you wanna to realize, our sales engineer will recommend suitable model for you.*